

1

2

3

4

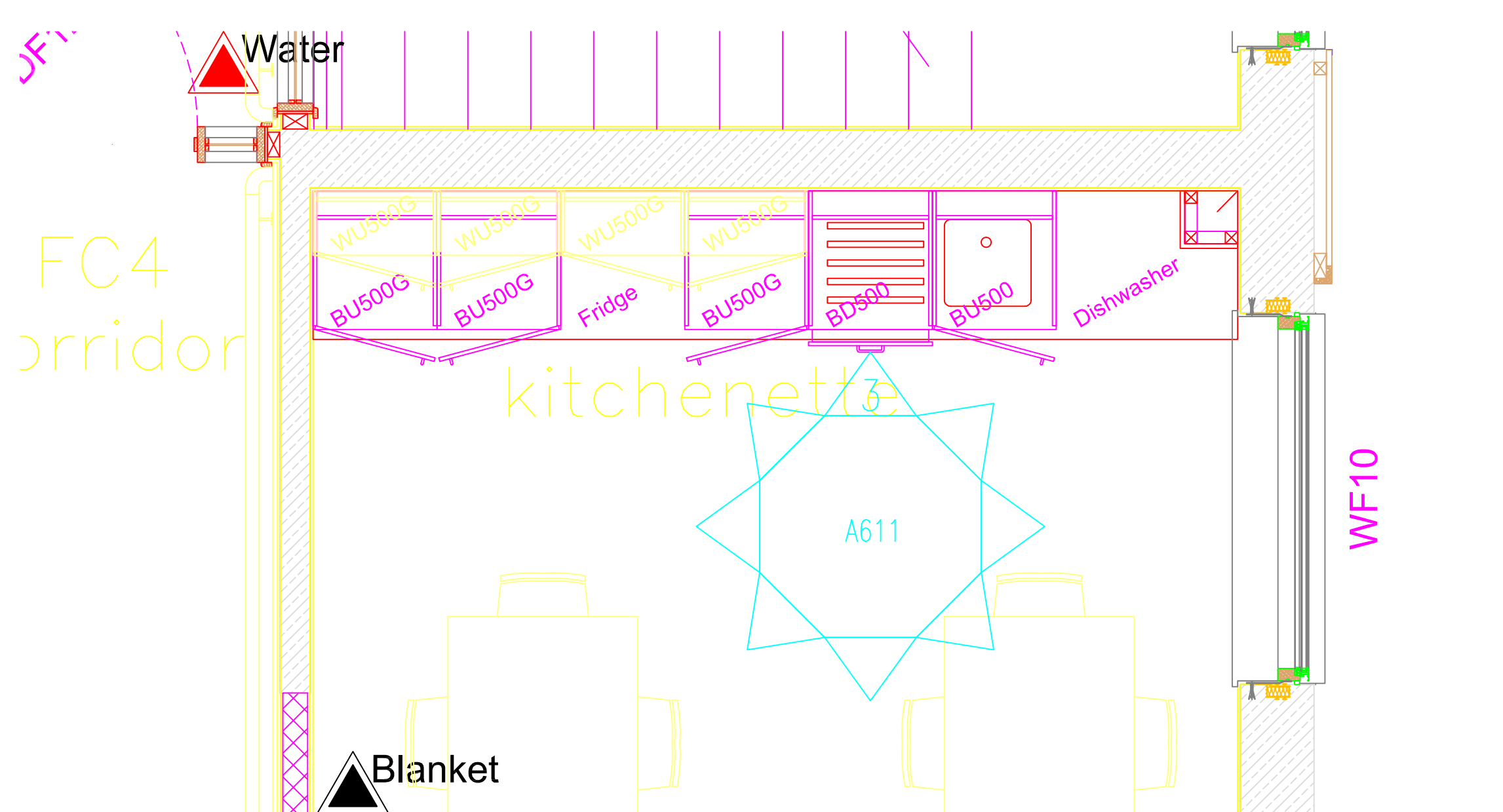
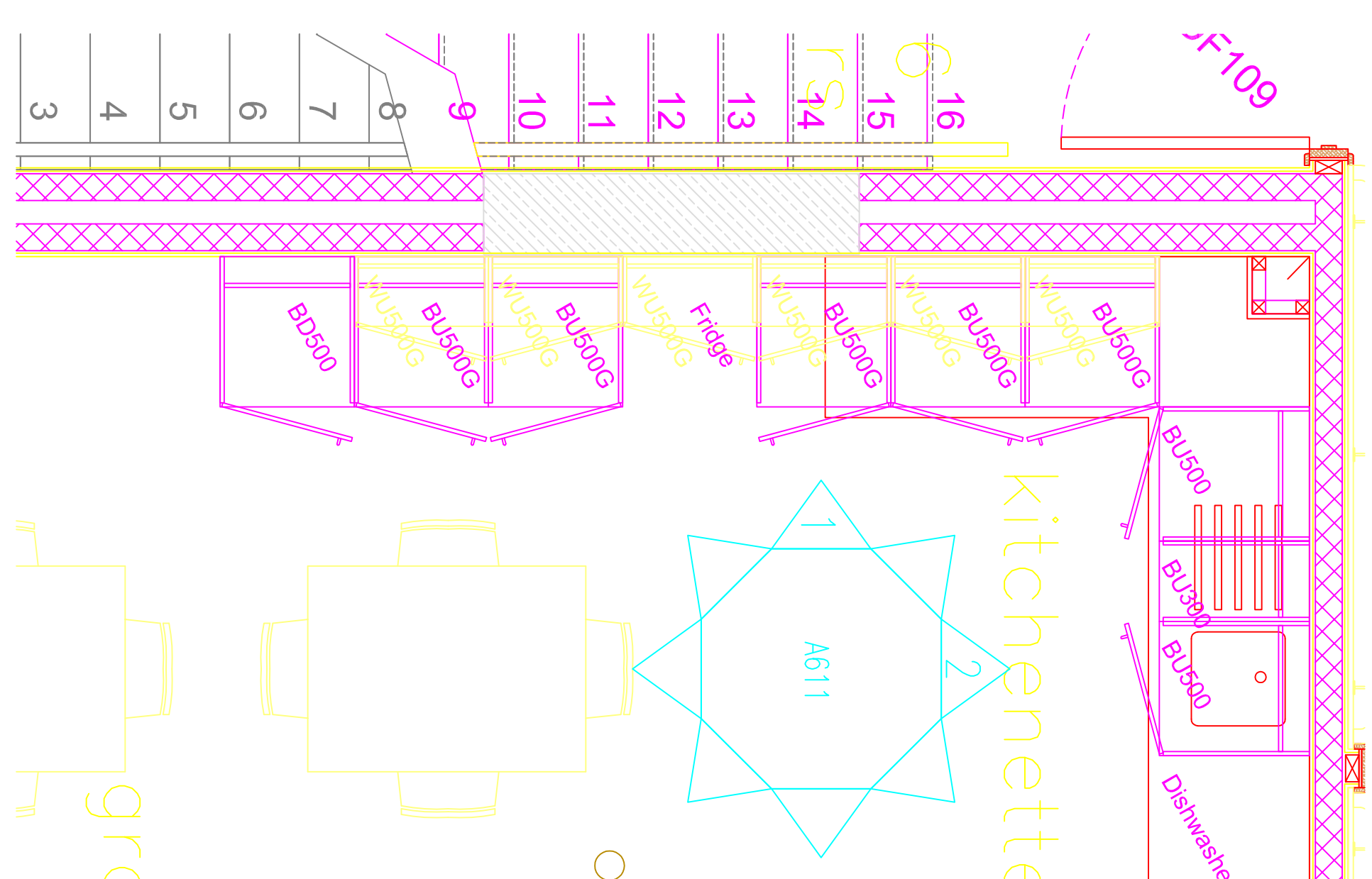

# First Floor

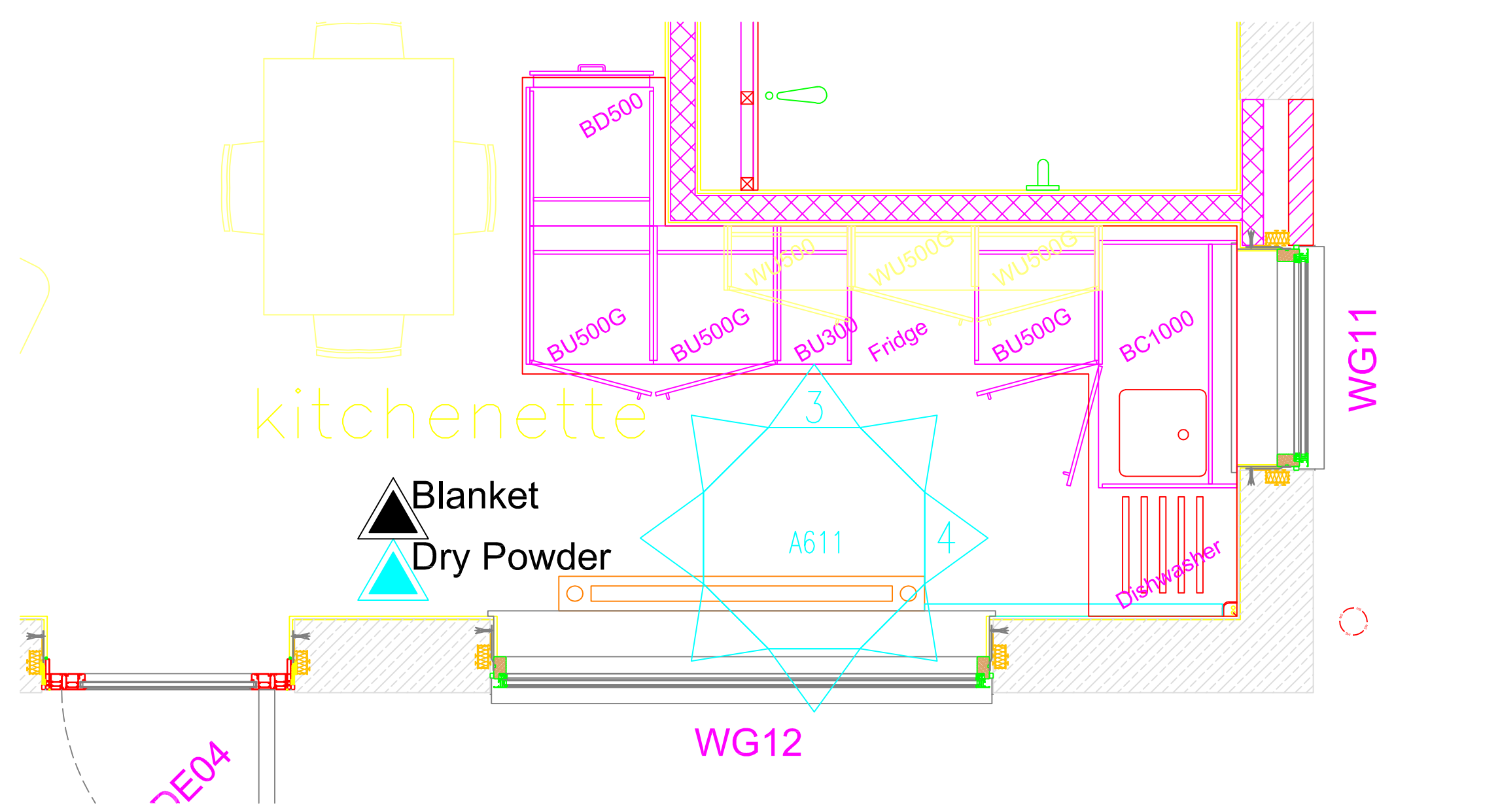
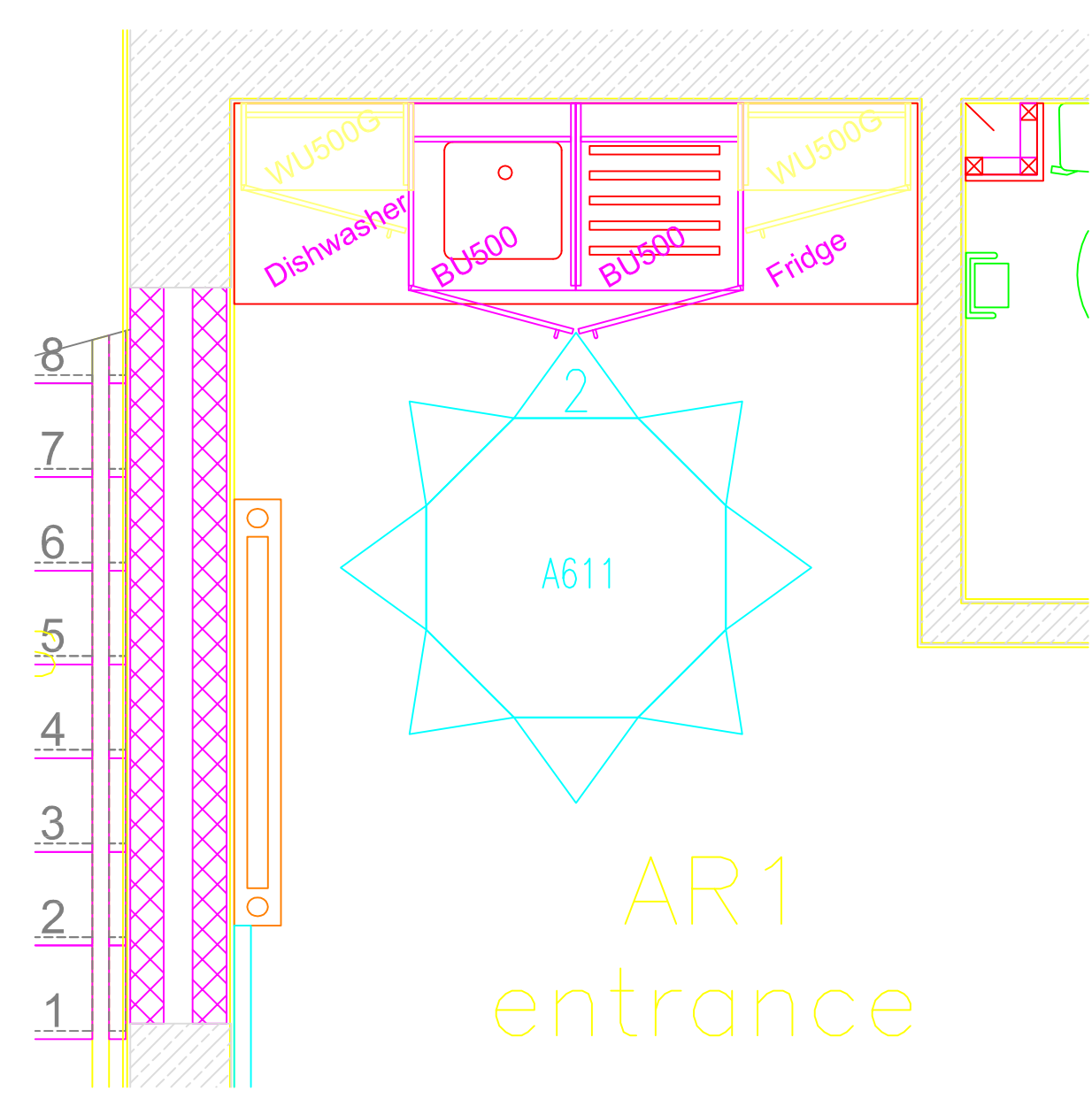
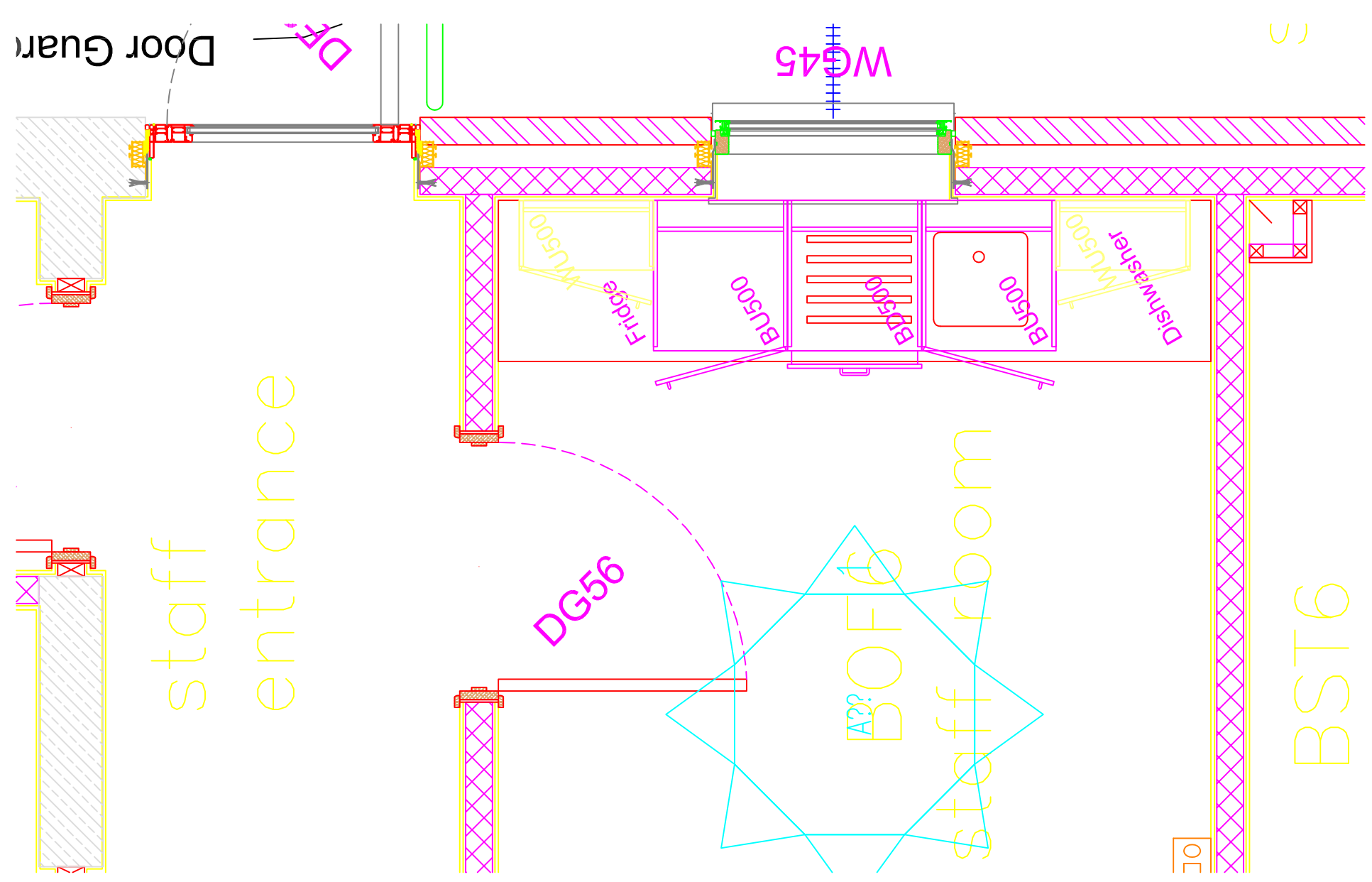

# Ground Floor

- Notes:**
- This document is the property of Nottingham City Council and may not be used, copied or reproduced in whole or in part in anyway without express prior written consent.
  - Any Ordnance Survey map shown on this drawing is reproduced from Ordnance Survey material with the permission of Ordnance Survey on behalf of the Controller of Her Majesty's Stationery Office. Crown Copyright. Unauthorised reproduction is prohibited. Crown copyright and may lead to prosecution or civil proceedings. Nottingham City Council 100019317 2004.
  - Do not scale from this drawing. All dimensions to be taken from dimensioned drawings only. Dimensions shown are indicative and are to be checked on site prior to the commencement of work or ordering of any materials. Discovery of major discrepancies are to be immediately brought to the attention of the contract administrator.
  - All drawings to be read in conjunction with all other contract documents.
  - Asbestos:** Upon the discovery of any suspected asbestos based materials the contractor shall immediately stop all work and inform the contract administrator and health and safety advisor to confirm what further actions are required. All asbestos materials identified for removal must be removed by an approved licensed contractor. A method statement will be required for these works.

Revisions:	Drawn:	Checked:	Date:

City of  
**NOTTINGHAM**  
Corporate Services  
Design and Property  
Design Services  
Sevens House  
20 Middle Pavement  
Nottingham  
Tel: 0115 915 5000  
Fax: 0115 915 8106

**Project**  
Bestwood EPH Refurbishment  
Fairlight Way, Bestwood Park

**Title**  
Kitchenettes  
1 of 2

Scale 1:20	Site Code No. (UPRN)	Plot Area Reference :
Drawn KNS	Checked KNS	Date July 2007

**A** Drawing No.  
SS96/611